

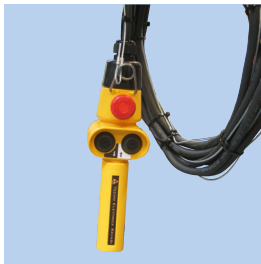

Photo:
Hose reel type SR7V02
- shown with additional
equipment (exhaust
nozzle type MOG)

SR7V02 10m

Superlight hose reel with completely mounted 230V-plug - ready for use!

- Can easily be mounted on the wall or under the ceiling
- Easily connected to piping by nipple
- Standard diameter: $\varnothing 76$, $\varnothing 100$, $\varnothing 125$ and $\varnothing 152$ mm
- Standard length: 10m
- Incl. automatic adjustable spindle stop
- Delivered incl. tool for spindle stop setting
- Reel is delivered with pendant hand control for un- and rewind
- Reel is delivered completely adjusted and wired incl. 230V-plug
- Hose for exhaust fumes with max. temperature 200°C that are added 50% cooling air.
Max. constant temperature for hose: 120°C



Hand control

Un- and rewind is easily controlled through pendant hand control. Time for un- and rewind of 10 m hose is approx. 20 sec.



Lever arm

Start/stop-signal by lever arm switch for fan or damper is available.

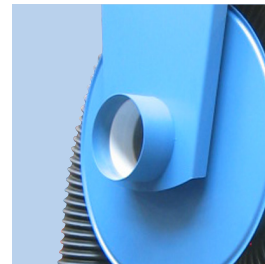

Connection piece

Connecting piece to ventilation unit. Lindab coupling can be used.



Remote control

Also available with remote control (see price group 1 or 9).

Hose reel type SR7V02 is delivered as standard with hose type S3B. Is available in $\varnothing 76$, $\varnothing 100$, $\varnothing 125$ or $\varnothing 150$ mm, and it is resistant to oil and gasoline as well as the chemical products that are contained in exhaust gases. The hose is wear resistant, flexible and can partly be run over. At extraction from tractors or construction machinery, the application of min. 3m high-temperature hose type S6 or S8 is recommended - depending on the temperature.

Equipment for Gram hose reel type SR7V02:

- Various rubber exhaust nozzles with grip clamp (price group 1)
- Various pneumatic rubber exhaust nozzles (price group 1)
- Automatic start and stop of possible fan or motor damper (price group 1 and 9)
- Remote control (price group 1 and 9)

Colour: RAL 5007 (structure)



Principle sketch

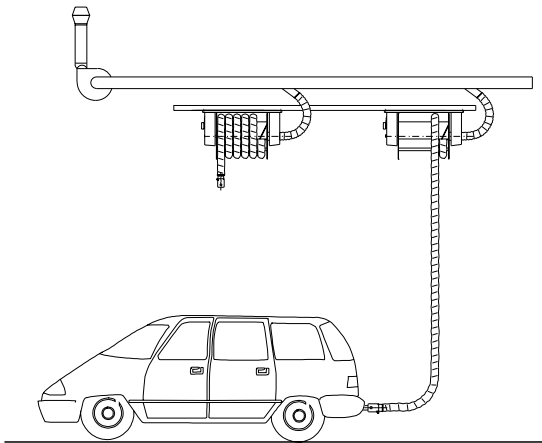

Safety coupling type SKB for application at vehicles:

- For low vacuum (max. 1,500Pa)
- Consisting of male and female components made in cast rubber/steel
- Disconnection occurs at straight pull of min. 60kg dependent on temperature
- Max. temperature: 0-150°C
- Delivered incl. NPU-nipples $\varnothing 100\text{mm}$

Type	Order no..	Diameter [mm]
SKB	08 599 000	$\varnothing 100$
SKB	08 599 100	$\varnothing 150$

Mounting:

Easily done with 4 bolts at wall, ceiling or ceiling structure

Stabile structure required

Can be connected to existing piping

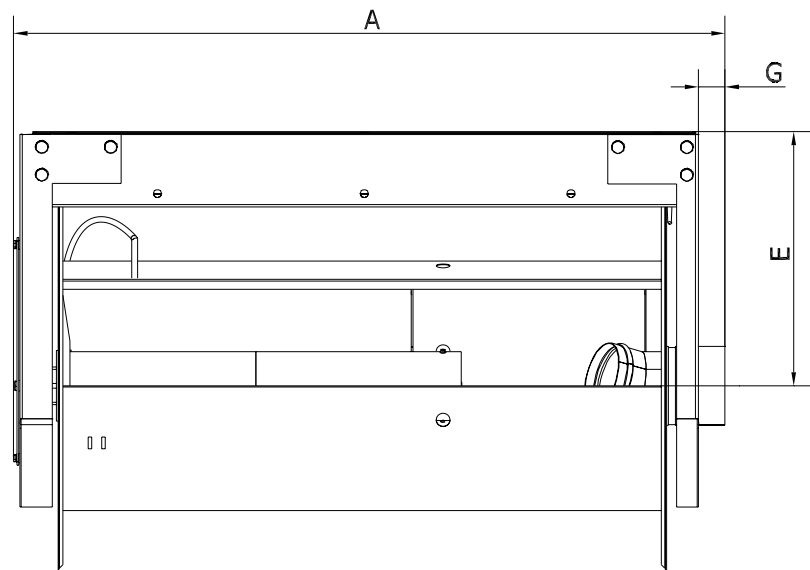
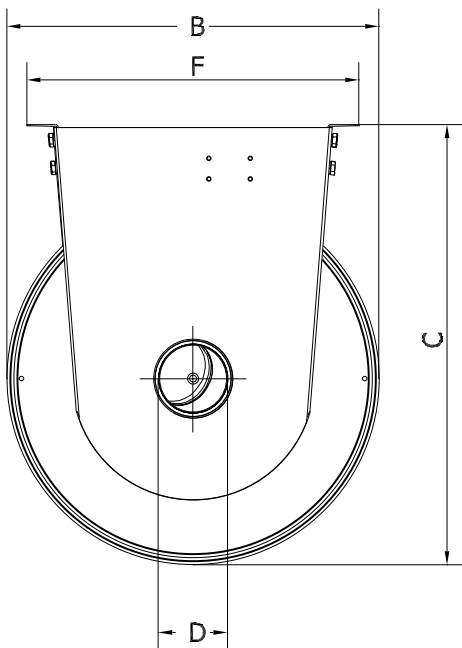

Order no.	Type -	Hose length /	Hose diameter [mm]	A	B	C	D	E	F	G	Air volume [m ³ /h]	Pressure drop [Pa]	Weight [kg]
01 800 250	SR7V02 -	10m /	$\varnothing 76$	1039	539	639	100	369	481	40	250	800	55
01 801 250	SR7V02 -	10m /	$\varnothing 100$	1039	539	639	100	369	481	40	450	800	60
01 802 250	SR7V02 -	10m /	$\varnothing 125$	1171	658	784	160	455	481	73	700	750	75
01 803 250	SR7V02 -	10m /	$\varnothing 150$	1171	658	784	160	455	481	73	1000	750	80

Rev. 12.22 Data is subject to alterations