

RFF-A 2000 - 9000

- For ATEX zone 21/1 (2D/2G)
- Very large motion pattern - vertical
- Very lightweight extraction arm
- RFF-A can rotate free 360° for hose relief
- Mountings for wall
- Length 2 - 4m is connected to channel by nipple
- Length 5 - 9m is connected to channel by hose (not inclusive)
- With fixed-mounted, powder enamelled steel pipes for optimal flow and design
- Construction with external bar system
- Flow technical optimized hood
- Suitable for smoke, light dust and gases

ATEX zone 21 and 1

- Hose type S9-A in electrically conductive polyethylene with spirale in spring steel wire
- Hose bracket made in plastic
- Arm tested for electrical resistance in bonding circuit 2 - 30 Ohm. Resistance from arm surface to earthing must be less than 1G Ohm.
- Arm made with earth wire for earthing after mounting (see above)
- Hood made with manual damper. Packing in damper: Fabric rubber and handle in plastic.

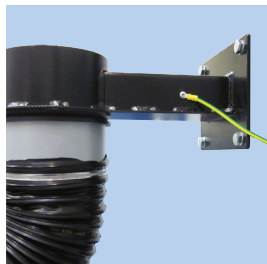

RFF-A 2000 - 4000
Wall fitting with earth cable.

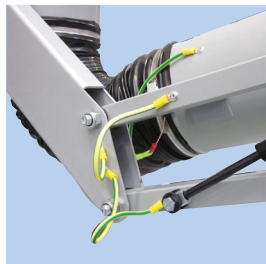

Bend
Bend bottom with earth cable connections to parallelogram.

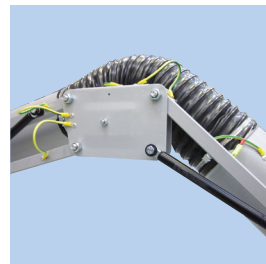

Joint
Intermediate plates at top joint with relief cables between construction parts.



Hood
Hood additional joint and external arm connected with earth cables. Hood can angle in two directions.

Diameter	Hose type	Max. vacuum	Damper	See page
ø125-ø160mm	S9-A	1500 Pa	Yes	Group 8

The fixed, powder enamelled steel pipes provide the arm with a nice and exclusive look. RFF-A arm is designed with external joints, meaning air flow is increased, hose does not wear and service and adjustment are made easy.



Colour: RAL 9005/colour code 9965 silver (structure)

Type RFF-A 2000 - 4000:

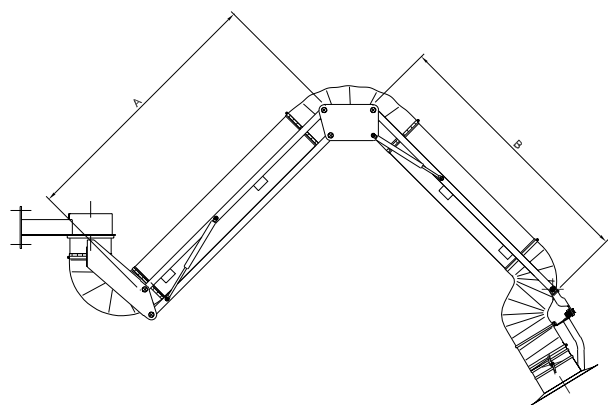

Type	Order no.	A	B	Hose diameter
RFF-A 2000	10 133 000	500	450	ø125-ø160mm
RFF-A 3000	10 133 050	1000	900	ø125-ø160mm
RFF-A 4000	10 133 100	1500	1400	ø125-ø160mm

Range RFF-A 2000 - 4000 (ø160mm):

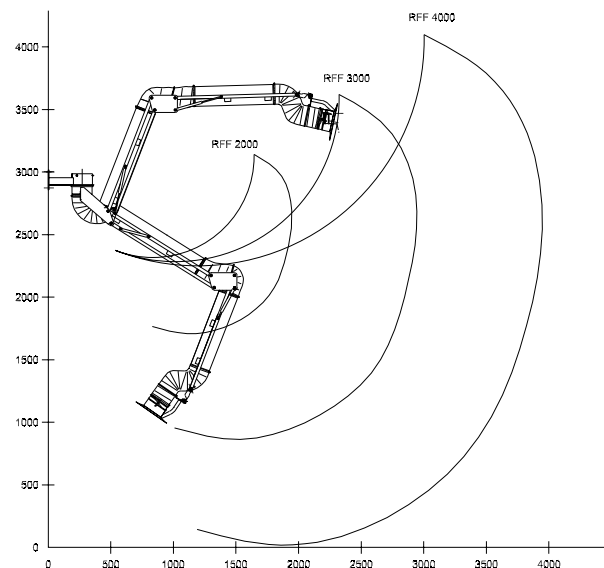

Extraction arm type RFF-A with extension arm/single swing arm:

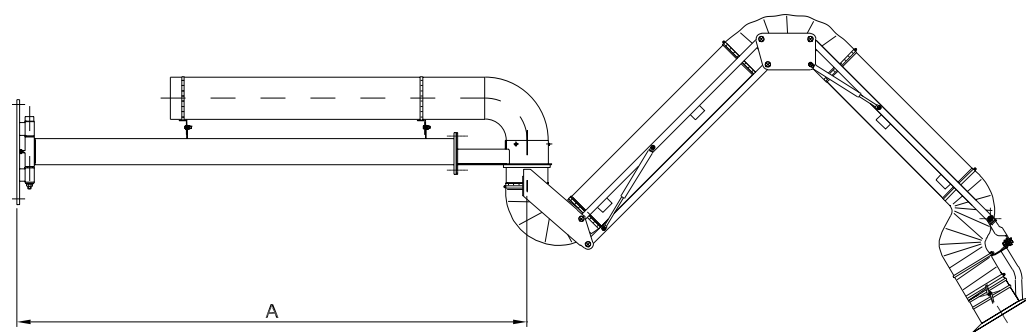

Type	A	Hose diameter	Range (ø160mm)
RFF-A 4000E	1050	ø125-ø160mm	3950
RFF-A 5000	1950	ø125-ø160mm	4850

Extension arm/double swing arm, max. 9m (can be folded together against wall):

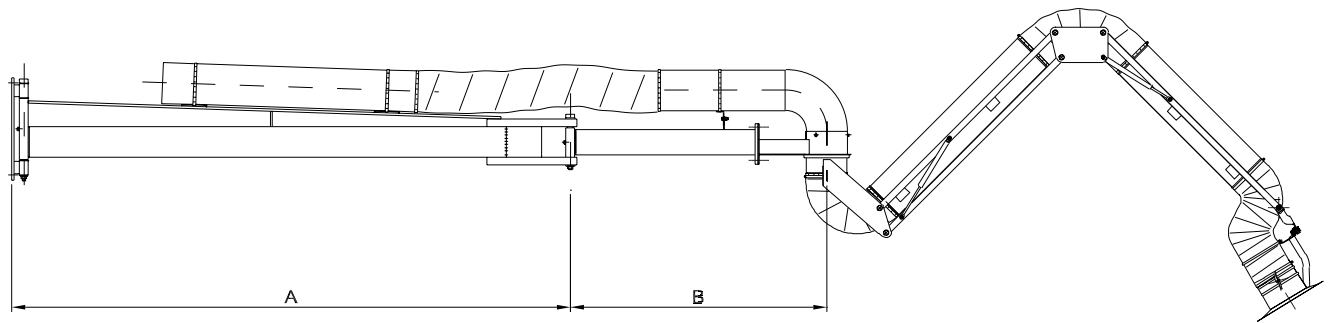

Type	A	B	Hose diameter	Range (ø160mm)
RFF-A 6000	2185	1000	ø125-ø160mm	6085
RFF-A 7000	2185	1895	ø125-ø160mm	6980
RFF-A 8000	3185	1895	ø125-ø160mm	7980
RFF-A 9000	3185	1895	ø125-ø160mm	8980

Performance curve for RFF-A 2000 - 4000 (ø125 - ø160mm):

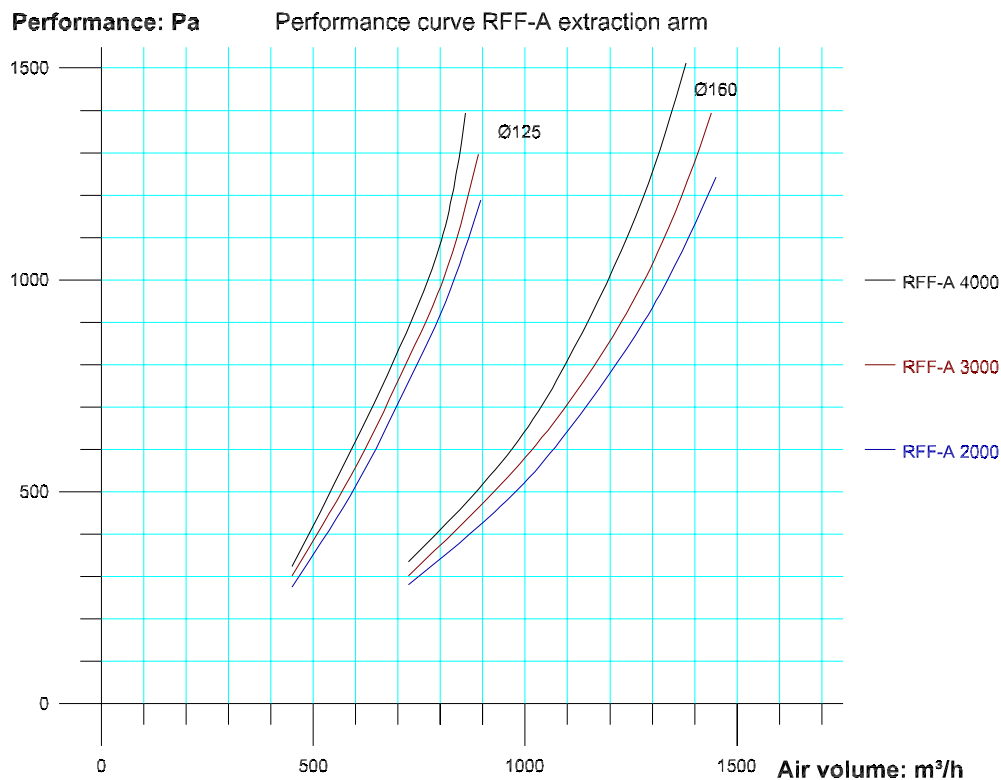

Performance table for cantilever joints for RFF-A (ø125 - ø160mm):

Diameter	ø125mm	ø160mm
at m³/h	600	1000
2m joint	70 Pa	70 Pa
2m + 1m joint	150 Pa	150 Pa
2m + 2m joint	185 Pa	185 Pa
3m + 2m joint	220 Pa	220 Pa